

SP-5B90 eXtreme Box Module

SP5000X SERIES



Features:

- Enhanced maintenance process.
- Modular design
- Class 1 Div 2, Groups A, B, C, and D
- Combine with any SP-5000x Series Display
- Conformal Coated
- NEMA 4X Outdoor Rated (3C3 model)

Performance Specifications

Model	SP-5B90 eXtreme Box		
Part Numbers	PFXSP5B90	PFXSP5B90F0H	
For use in Harsh and Corrosive Environments (3C3)	No	Yes	
Application Memory	On board Flash (1 GB)		
Backup Memory	NVRAM 512 KB *1		
Interfaces	Serial	COM1	RS-232C / 422 / 485, Data Length: 7 or 8 bits, Stop Bit: 1 or 2 bits, Parity: None, Even or Odd, Data Transmission Speed: 2,400 (1,200) to 115,200 bps, Connector: D-Sub 9 pin (plug)
		COM2	RS-232C / 422 / 485, Data Length: 7 or 8 bits, Stop Bit: 1 or 2 bits, Parity: None, Even or Odd, Data Transmission Speed: 2,400 (1,200) to 115,200 bps, Connector: D-Sub 9 pin (plug)
	Ethernet	Standard: IEEE802.3i/IEEE802.3u/IEEE802.3ab, 10BASE-T/100BASE-TX Connector: Modular jack (RJ-45) x 2	
	USB	Type A (V2.0) x2, Mini B (V2.0) x1	
	SD Card	SD Card slot (System) x 1 SD Card slot (Storage) x 1	
	Ethernet	IEEE802.3i/IEEE802.3u/IEEE802.3ab, 10BASE-T/ 100BASE-TX/ 1000BASE-T*2	
	Expansion unit	Fieldbus Unit x 1	
	Sound output	Speaker Output: 300mW (Rated Load: 8Ω, Frequency: 1kHz) (Software Switch), LINE Output: Rated load: 10kΩ or more (Software Switch), Connector: 2-piece terminal block (AUX) x 1	
	AUX Output Interface	Alarm output/Buzzer output, Rated voltage 24Vdc, Rated current, 50 mA, Connector 2-piece terminal block (AUX) x1	

*1 Amount of memory you can use depends on your screen editing software. For information refer to the manual of your screen editing software.
*2 For 1000BASE-T communication, use twisted pair Ethernet cables with a rating of category 5e or higher.

General Specifications

Model	SP-5B90 Box
Part Numbers	PFXSP5B90, PFXSP5B90F0H
Rated Input Voltage	12 Vdc (Supply from Display Module)
Power Consumption	20 W Max (primary power supply including power loss)
Cooling Method	Natural air circulation
Weight	0.9kg[1.98lb] or less
External Dimensions	W188 x H131 x D45mm [W7.4 x H5.16 x D1.77 in.]
Warranty	Two (2) years

Note: Box Module environmental specifications follow those of the connected Display Module.

Model Number Configuration

Display Module

PFXSP5 * * * * *

(1) (2) (3) (4) (5)

(1) Size	(2) Wireless LAN	(3) Resolution	(4) Touch Panel	(5) Power Supply
7 15"	90 eXtreme	W Wide TFT	A Analog	D DC
6 12"				
4 7"				

×

Box Module

PFXSP5 B * *

(6) (7)

(6) Module Type	(7) Class
B Box	90 eXtreme

External Dimensions

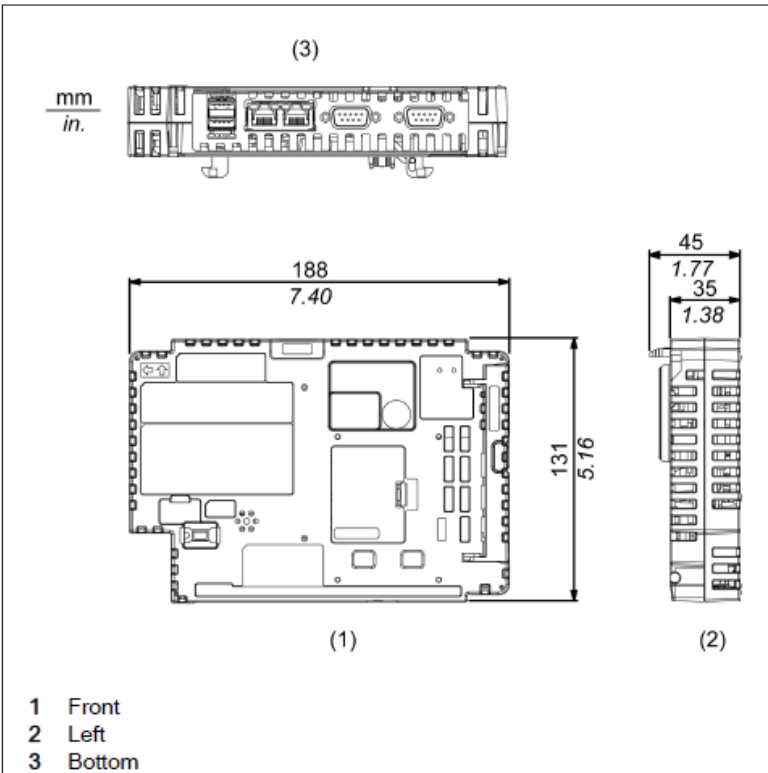

Easy Maintenance and Modularity

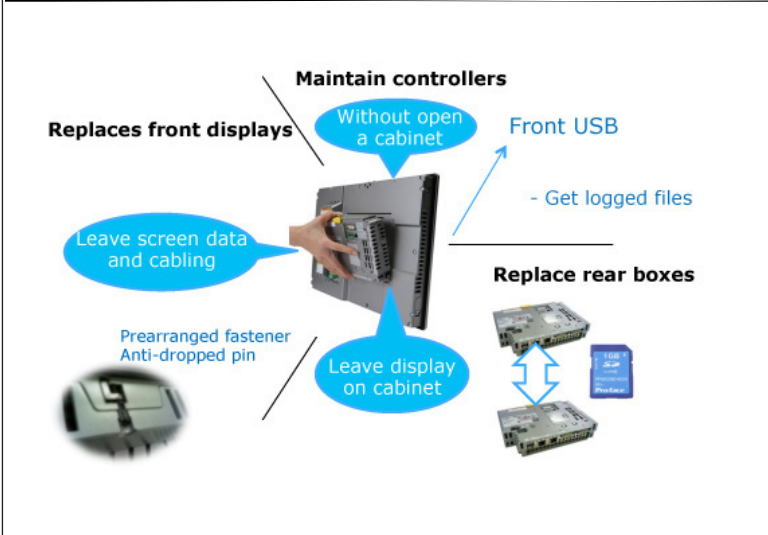

Ordering Information

Model Number	Description
PFXSP5B90	SP5000X Series eXtreme Box Outdoor use, Rugged, Coated, Ethernet I/F x 2, COM I/F x 2, USB A I/F x 2, USB mini-B I/F, SD Card I/F x 2, AUX I/F, Expansion Unit I/F
PFXSP5B90F0H	SP5000X Series eXtreme Box Outdoor use, plus harsh and corrosive environments (3C3) Rugged, Coated, Ethernet I/F x 2, COM I/F x 2, USB A I/F x 2, USB mini-B I/F, SD Card I/F x 2, AUX I/F, Expansion Unit I/F..

Options

Part Number	Description
PFXZCDS1GC61	SD Memory Card (1 GB, SLC, Class 6)
PFXZCHBMFBS1	SP5000X Series, Bracket for fixing Box module to Display module(SP-5490WA) (1 piece)
PFXZCHBMFBL1	SP5000X Series, Bracket for fixing Box module to Display module (1 piece)
PFXZCHFUB1	SP5000 Series/SP5000X Series, Bracket for fixing Fieldbus unit to Box module (1 piece)
PFXZCBCLUSA1	Clamp to prevent disconnection of USB cable (USB Type A, 1 port, 5 clamps/set)
PFXZCDS1GC61	SD memory card (1 GB, SLC) for System Card

EXTREME Solutions



Oil & Gas



Water/Waste Water



Pumping Station



Transportation

Pro-face America
 Phone: 734.477.0600
 Fax: 734.864.7347
 www.profaceamerica.com

Customer Service Hotline: 800.289.9266

For more information
ACCESS www.profaceamerica.com

Pro-face



California Proposition 65 Warning—Lead and Lead Compounds

Advertencia de la Proposición 65 de California—Plomo y compuestos de plomo

Avertissement concernant la Proposition 65 de Californie—Plomb et composés de plomb

⚠ WARNING: This product can expose you to chemicals including lead and lead compounds, which are known to the State of California to cause cancer and birth defects or other reproductive harm. For more information go to: www.P65Warnings.ca.gov.

⚠ ADVERTENCIA: Este producto puede exponerle a químicos incluyendo plomo y compuestos de plomo, que es (son) conocido(s) por el Estado de California como causante(s) de cáncer y defectos de nacimiento u otros daños reproductivos. Para mayor información, visite : www.P65Warnings.ca.gov.

⚠ AVERTISSEMENT: Ce produit peut vous exposer à des agents chimiques, y compris plomb et composés de plomb, identifiés par l'État de Californie comme pouvant causer le cancer et des malformations congénitales ou autres troubles de l'appareil reproducteur. Pour de plus amples informations, prière de consulter: www.P65Warnings.ca.gov.

All trademarks are the property of Schneider Electric SE, its subsidiaries, and affiliated companies.

Schneider Electric USA, Inc.
800 Federal Street
Andover, MA 01810 USA
888-778-2733
www.schneider-electric.us

Todas las marcas comerciales son propiedad de Schneider Electric SE, sus filiales y compañías afiliadas.

Importado en México por:
Schneider Electric México, S.A. de C.V.
Av. Ejercito Nacional No. 904
Col. Palmas, Polanco 11560 México, D.F.
55-5804-5000
www.schneider-electric.com.mx

Toutes les marques commerciales sont la propriété de Schneider Electric SE, ses filiales et compagnies affiliées.

Schneider Electric Canada, Inc.
5985 McLaughlin Road
Mississauga, ON L5R 1B8 Canada
800-565-6699
www.schneider-electric.ca